

1. Figure

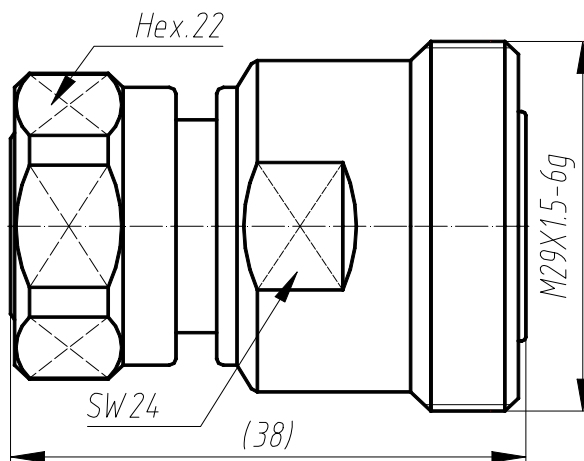

2. Product Description

4310M-DINF

4.3-10 straight male to DIN straight female adapter

3. Material and Plating

Center contact	Tin-bronze / Silver Plated
Outer contact & Body	Brass / Silver Plated
Dielectric	PTFE
Gasket	Silicon Rubber
Nut	Brass / Nickel Plated

4. Electrical Characteristics

Characteristics Impedance	50 Ohm	
Frequency Range	DC~6GHz	
Insulation Resistance	≥10000MΩ	
Contact resistance	4.3-10 type	DIN type
Center contact	≤1.5mΩ	≤0.4mΩ
Outer contact	≤1.5mΩ	≤0.2mΩ
Dielectric Strength	2500V rms	
Working voltage	1400V rms	
Insertion Loss	≤0.10dB@DC~3GHz	
VSWR	≤1.05@DC~3.0GHz	
PIM(2x43dBm)	≤-160dBc	

5. Environmental and Mechanical Specifications

Durability (matings)	≥500 cycles
Thermal Shock Test Method	MIL-STD-202F, Method 107G, Test Condition B
Vibration Test Method	MIL-STD-202, Meth. 204, Cond. B
Temperature Range	-65~+165°C
RoHS	Compliant

The facts and figures contained herein are carefully complied to the best of our knowledge, but they are intended for